



# INSTALLATION

## ExSite<sup>®</sup>/ExSite IP Series Explosionproof Pan/Tilt System



C1302M-I (11/12)



# Contents

---

Important Safety Instructions .....	5
Description .....	6
Parts List .....	6
Methods of Installation .....	7
Installing the Camera Module .....	8
Installing the Pan/Tilt Unit .....	11
Installing the Sun Shroud .....	13
Maintenance .....	14
Camera Module Replacement .....	14
Specifications .....	18

**SCHEDULE DOCUMENT**  
**This document cannot be changed without prior regulatory review.**

# List of Illustrations

---

- 1 Standard and Inverted Installations ..... 7
- 2 Attach an Earth Ground ..... 7
- 3 Loosen the Setscrew ..... 8
- 4 Remove the Back Cap of the Enclosure ..... 8
- 5 Install the Camera Module ..... 9
- 6 Center the Wiper Blade ..... 9
- 7 Install the Wiper Arm ..... 10
- 8 Factory-Installed Power Module Seal ..... 11
- 9 Attach the Pan/Tilt to the Power Module ..... 11
- 10 Install the Sun Shroud ..... 13
- 11 Remove the Back Cap of the Camera Enclosure ..... 14
- 12 Remove/Install the Camera Module ..... 15
- 13 Install the Camera Module ..... 16
- 14 Center the Wiper Blade ..... 16

# Important Safety Instructions

---

1. Read these instructions.
2. Keep these instructions.
3. Heed all warnings.
4. Follow all instructions.
5. Do not block any ventilation openings. Install in accordance with the manufacturer's instructions.
6. To reduce the risk of ignition of hazardous atmospheres, disconnect the equipment from the supply circuit before opening. Keep assembly tightly closed when in operation.
7. The maximum ambient temperature range is -76° to 140°F (-60° to 60°C).
8. Only use attachments/accessories specified by the manufacturer.
9. Refer all servicing to qualified service personnel. Servicing is required when the apparatus has been damaged in any way, such as power-supply cord or plug is damaged, liquid has been spilled or objects have fallen into the apparatus, the apparatus has been exposed to rain or moisture, does not operate normally, or has been dropped.
10. Installation should be done only by qualified personnel and conform to all local codes.
11. Unless the unit is specifically marked as a NEMA Type 3, 3R, 3S, 4, 4X, 6, or 6P enclosure, it is designed for indoor use only and it must not be installed where exposed to rain and moisture.
12. Use only installation methods and materials capable of supporting four times the maximum specified load.
13. Use stainless steel hardware to fasten the mount to outdoor surfaces.
14. AN ALL-POLE MAINS SWITCH with a contact separation of at least 3 mm in each pole shall be incorporated in the electrical installation of the building.
15. A readily accessible disconnect device shall be incorporated in the building installation wiring.
16. **CAUTION:** These servicing instructions are for use by qualified service personnel only. To reduce the risk of electric shock do not perform any servicing other than that contained in the operating instructions unless you are qualified to do so.
17. Only use replacement parts recommended by Pelco.
18. A certified flameproof, "d," sealing device such as a stopping box with setting compound shall be provided, either in the flameproof enclosure or immediately at the entrance thereto.
19. For ambient temperatures below 14°F (-10°C) use field wiring suitable for both minimum and maximum ambient temperature.

The product and/or manual may bear the following marks:

 **WARNING:** This symbol indicates that dangerous voltage constituting a risk of electric shock is present within this unit.

 This symbol indicates that there are important operating and maintenance instructions in the literature accompanying this unit.

 **WARNING:** HAZARDOUS MOVING PARTS. KEEP FINGERS AND OTHER BODY PARTS AWAY.

 **WARNING:** To reduce the risk of ignition of hazardous atmospheres, disconnect the equipment from the supply circuit before opening. Keep assembly tightly closed when operating.

 **WARNING:** To reduce the risk of ignition of hazardous atmospheres, conduit runs must have a sealing fitting connected within 2 inches of the enclosure.

 **TO REDUCE THE RISK OF IGNITION DO NOT OPEN WHEN AN EXPLOSIVE GAS ATMOSPHERE MAY BE PRESENT.**

<b>CAUTION:</b>
<b>RISK OF ELECTRIC SHOCK. DO NOT OPEN.</b>

# Description

---

ExSite®/ExSite IP Series are innovative integrated positioning systems that meet stringent explosionproof requirements, combining a receiver, pan/tilt, and camera in a single, easy-to install package.

The ExSite IP Series system has all of the features and functionality of the analog ExSite Series and includes a built-in 100Base-TX network interface for live streaming using a standard Web browser.

Both analog and network systems are available with a choice of power module: input voltage of 24 VAC or 100 to 240 VAC.

This manual includes instructions for installing the camera and pan/tilt unit.

 **WARNING:** Install the ExSite/ExSite IP Series power module before you install the camera and pan/tilt. For instructions on how to install the power module, refer to the manual included with the power module.

Once the system installation is complete, refer to the operation manual available on the resource disc for instructions on how to operate and your system.

## PARTS LIST

### PAN/TILT SYSTEM

Qty	Description
-----	-------------

- |   |                                   |
|---|-----------------------------------|
| 1 | Enclosure (with or without wiper) |
| 1 | Camera module                     |
| 1 | Sun shroud                        |
| 1 | Sun shroud hardware pack          |
| 2 | Screws, 6-32 Phillips, pan head   |
| 2 | Nylon washers                     |
| 1 | Spanner wrench                    |
| 2 | Allen wrench, 1.5 mm              |
| 2 | Allen wrench, 2 mm                |

### MODELS WITH A WIPER

Qty	Description
-----	-------------

- |   |                                 |
|---|---------------------------------|
| 1 | Wiper arm                       |
| 1 | Green bushing                   |
| 1 | Screw, 8-32 Phillips, flat head |

## METHODS OF INSTALLATION

The system can be installed in a standard or inverted position. When installed for inverted operation, the camera orientation and controller functions are reconfigured for normal operation through the system's software. Hardware adjustment is not required for inverted operation.

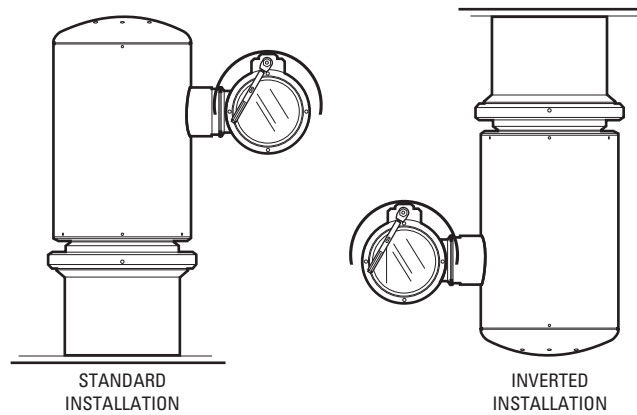

**Figure 1.** Standard and Inverted Installations

**⚠ WARNING:** The total weight of the pan/tilt component is 25 kg (55 lb). Use caution when lifting and assembling the pan/tilt component on the power module. It is recommended that non-slip gloves be worn during installation.

During installation, it is important to attach a 10 AWG copper stranded wire (minimum requirement) from the earth ground attachment point on the unit to an appropriate grounding location for your installation.

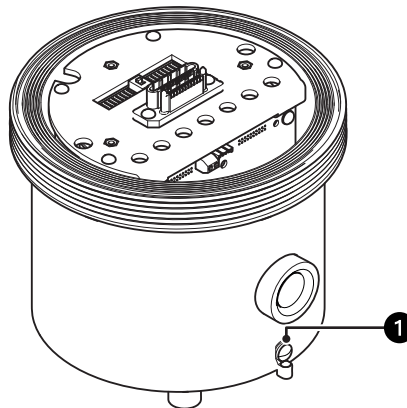
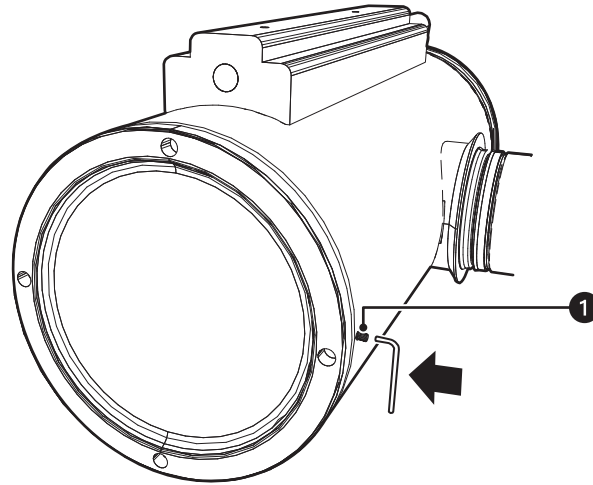

**Figure 2.** Attach an Earth Ground

① Earth Ground Attachment Point

# Installing the Camera Module

1. Loosen the setscrew at the back of the enclosure with the 1.5 mm Allen wrench (supplied).

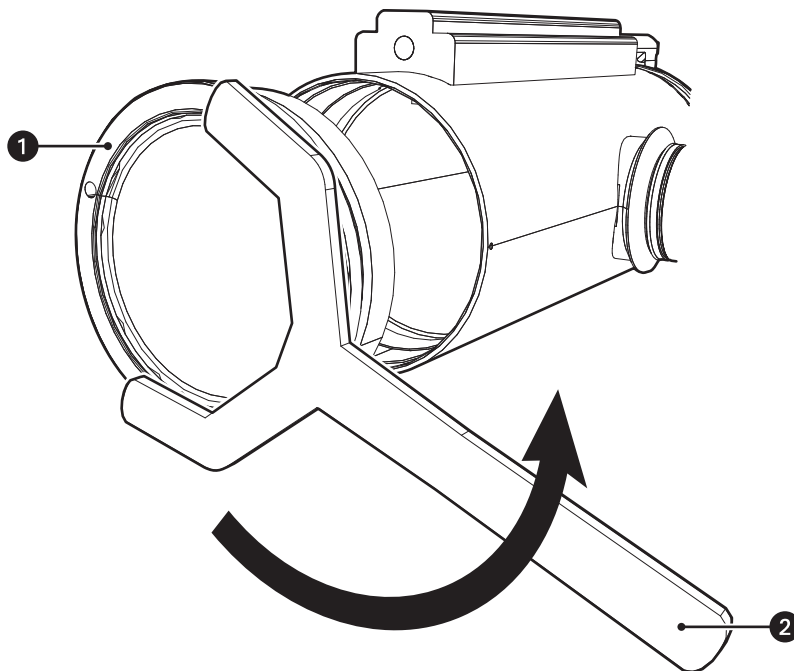

**Figure 3.** Loosen the Setscrew

① Setscrew

2. Use the spanner wrench (supplied) to loosen the back of the camera enclosure (refer to Figure 4). Once the back is loose, use your hands to continue to loosen it until it can be removed.

⚠ **WARNING:** To avoid thread damage, carefully remove the back of the camera enclosure. Never use force to remove the back of the camera enclosure.



**Figure 4.** Remove the Back Cap of the Enclosure

① Back Cap of Enclosure

② Spanner Wrench

3. Slide the camera module into the enclosure. Refer to Figure 5 to position the camera module properly in the enclosure.

*(Models with a wiper)* The tab located inside the enclosure must be pointing down before installing the camera module (refer to Figure 5). To position the tab, place the wiper blade (located at the front of the enclosure) in the center of the viewing window (refer to Figure 6).

**⚠ WARNING:** Do not force the camera module into the enclosure.

4. Carefully mate the camera's power connector to the mating connector located inside the enclosure.

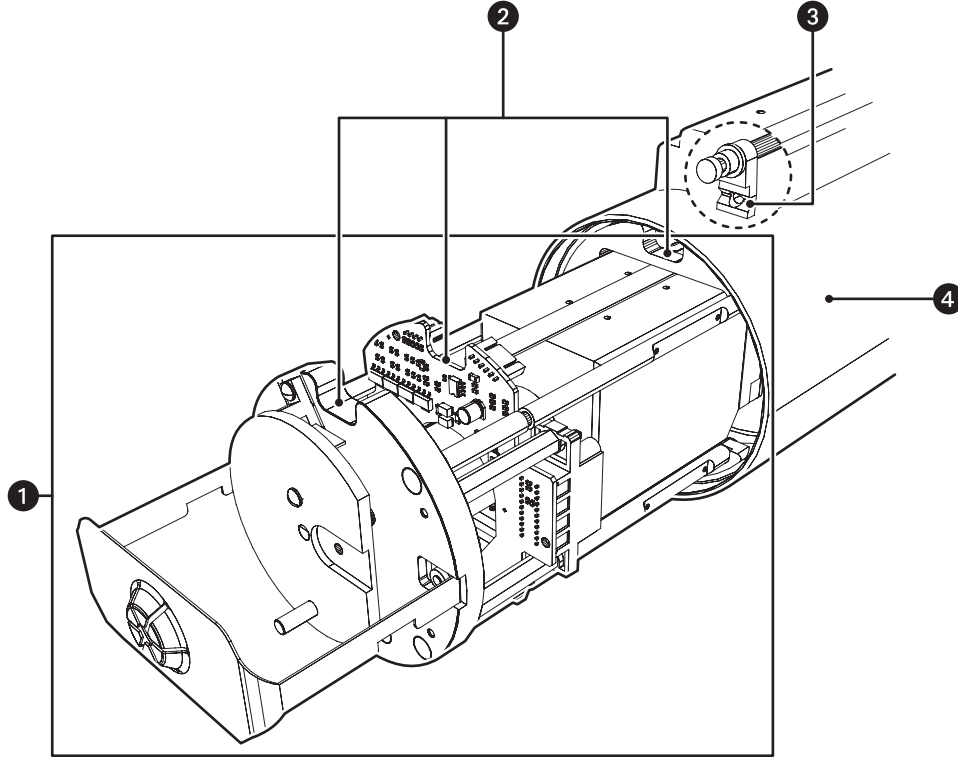

**Figure 5. Install the Camera Module**

- 1 Camera Module
- 2 Center Notches
- 3 Enclosure Tab
- 4 Camera Enclosure

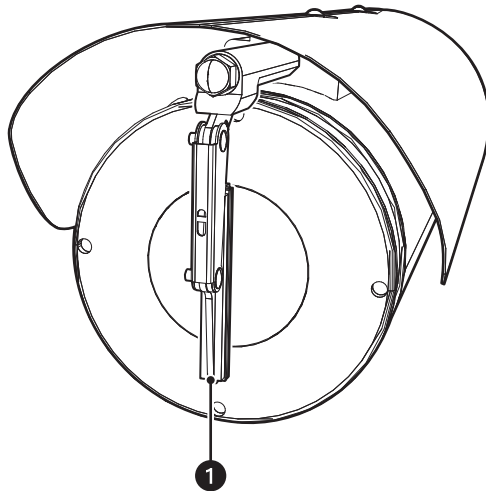

**Figure 6. Center the Wiper Blade**

- 1 Wiper Blade

5. *(Models with a wiper)* Install the wiper arm (refer to Figure 6).
  - a. Place the green bushing (supplied with wiper models) on the stud located behind the handle of the camera module. The bushing should be in the same orientation as shown in Figure 7.
  - b. Place the ridge of the wiper arm in the notch of the enclosure tab, and then place the slot of the wiper arm over the green bushing.
6. Secure the wiper arm with the 8-32 Phillips flat head screw (supplied with wiper models).

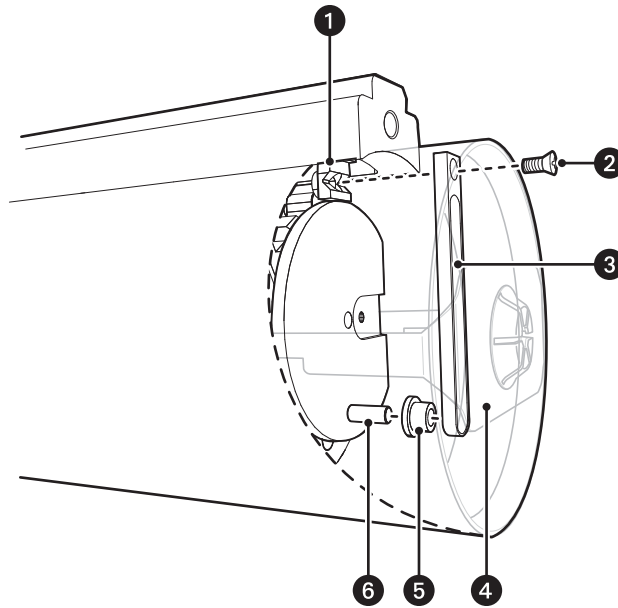

**Figure 7.** Install the Wiper Arm

- ① Enclosure Tab
- ② 8-32 Phillips Flat Head Screw
- ③ Wiper Arm
- ④ Camera Module Handle
- ⑤ Green Bushing
- ⑥ Stud

**⚠ WARNINGS:**

- To avoid thread damage, carefully install the back cap on the enclosure.
- Never force the back cap onto the end of the enclosure.
- When installation is completed, there should be no gap between the back cap and the enclosure.

7. Reinstall the back cap on the enclosure:
  - a. Using your hands, turn the back cap clockwise until you can no longer turn it. The back cap should turn easily until it comes in contact with the O-ring. If it does not turn easily, the threads are not aligned and thread damage will occur.
  - b. Continue tightening the back cap with the spanner wrench (supplied). There should be no gap between the back cap and the enclosure when the back cap is tightened and properly installed.
  - c. Once the back cap is installed, secure the back cap with the setscrew using the 1.5 mm Allen wrench (supplied).

# Installing the Pan/Tilt Unit

1. Verify that the power module seal is properly seated in the groove on the top of the power module.

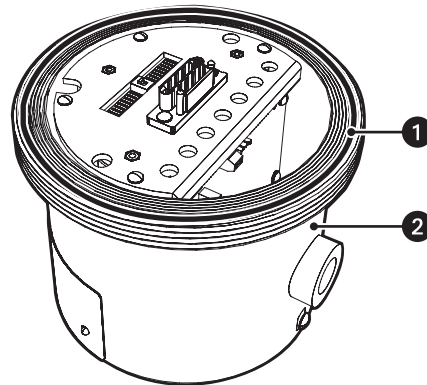
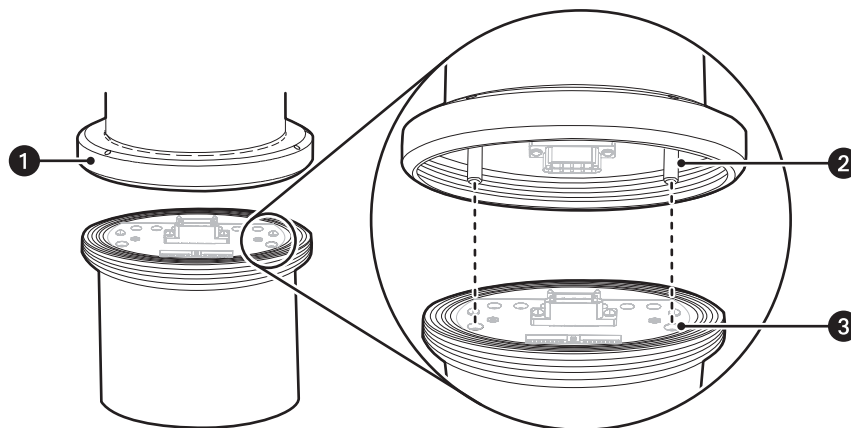

**Figure 8.** Factory-Installed Power Module Seal

- 1 Power Module Seal
- 2 Power Module

**⚠ WARNING:** Use caution when attaching the enclosure unit to the power module. If the grooves on the top of the power module are damaged, the integrity of the unit could be compromised.

2. Attach the pan/tilt unit to the power module.
  - a. Align the pins on the pan/tilt unit with the holes on the power module.
  - b. Carefully mate the pan/tilt connector to the power module connector.



**Figure 9.** Attach the Pan/Tilt to the Power Module

- 1 Locking Ring
- 2 Pins
- 3 Holes

**WARNINGS:**

- Total weight of the pan/tilt component is 25 kg (55 lb). Use caution when lifting and assembling the pan/tilt component on the power module.
  - The weight of the pan/tilt unit must be safely supported during installation.
  - It is recommended that non-slip gloves be worn during installation.
  - Avoid thread damage. Never use force when assembling and tightening the threaded components of the system.
3. Using your hands, carefully thread the pan/tilt locking ring onto the threads of the power module until the threads are completely engaged and can no longer be tightened by hand.
  4. Using the spanner wrench (supplied), continue to tighten the locking ring.
  5. Tap the spanner wrench handle with a hammer or the palm of your hand to ensure a secure fit.
  6. Tighten the locking ring setscrew with the 2 mm Allen wrench (supplied) to secure the assembly.

# Installing the Sun Shroud

---

1. Align the mounting holes on the sun shroud with the holes on top of the enclosure.
2. Insert the nylon washers (supplied with sun shroud hardware pack) and the 6-32 Phillips pan head screws (supplied with sun shroud hardware pack) into the mounting holes (refer to Figure 10).
3. Tighten the screws to secure the sun shroud to the enclosure.

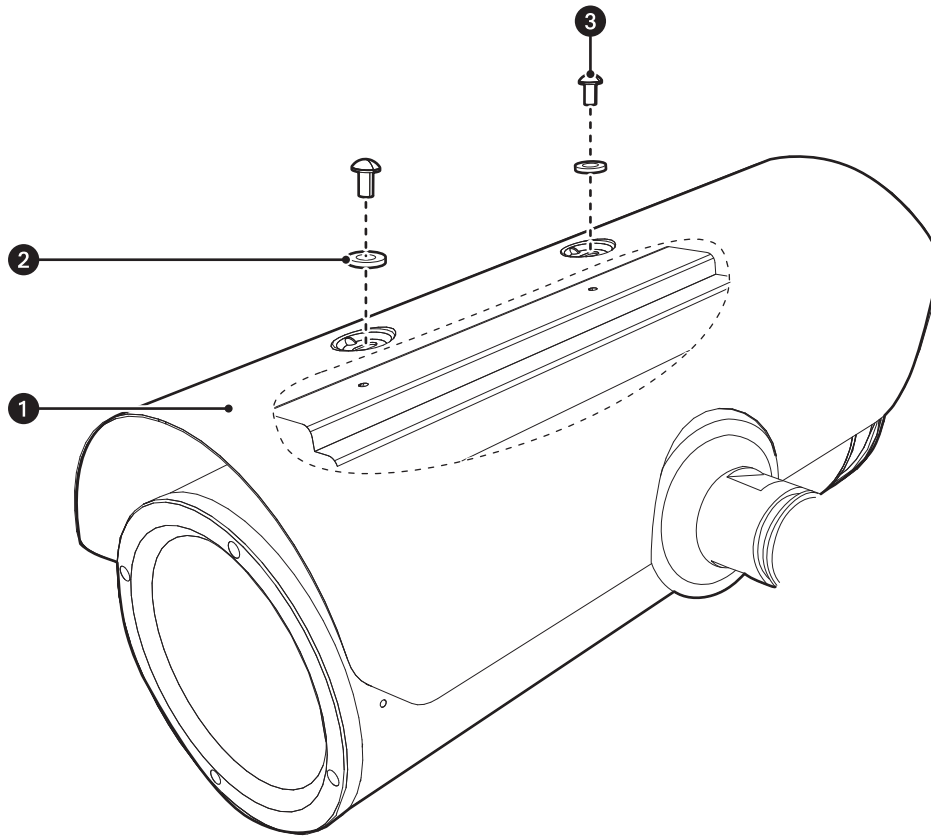

**Figure 10.** Install the Sun Shroud

- 1 Sun Shroud
- 2 Nylon Washers
- 3 6-32 Phillips Pan Head Screws

# Maintenance

---

## CAMERA MODULE REPLACEMENT

**⚠ WARNING:** To reduce the risk of ignition of hazardous atmospheres, disconnect the equipment from the power supply before opening. Keep the assembly tightly closed when operating.

To replace the camera module:

1. Remove the back cap of the camera enclosure (refer to Figure 11).
  - a. Loosen the setscrew with a 1.5 mm Allen wrench (supplied).
  - b. Use the spanner wrench (supplied) to loosen the back cap of the camera enclosure. Once the back cap is loose, use your hands to continue to loosen it until it can be removed.

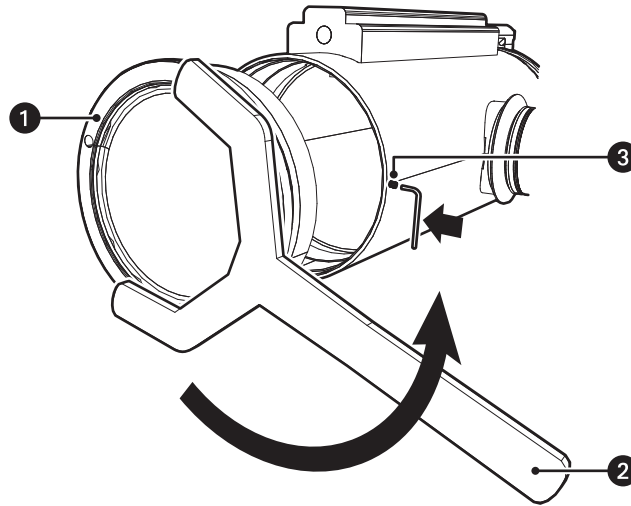

**Figure 11.** Remove the Back Cap of the Camera Enclosure

- ① Back Cap of Enclosure
- ② Spanner Wrench
- ③ Setscrew

2. *(Models with wiper)* Remove the 8-32 Phillips flat head screw (supplied with wiper models) that secures the wiper inside the enclosure.
3. *(Models with wiper)* Remove the wiper arm and the green bushing (supplied with optional wiper kit) from the unit.
4. Slide the camera module out of the enclosure.

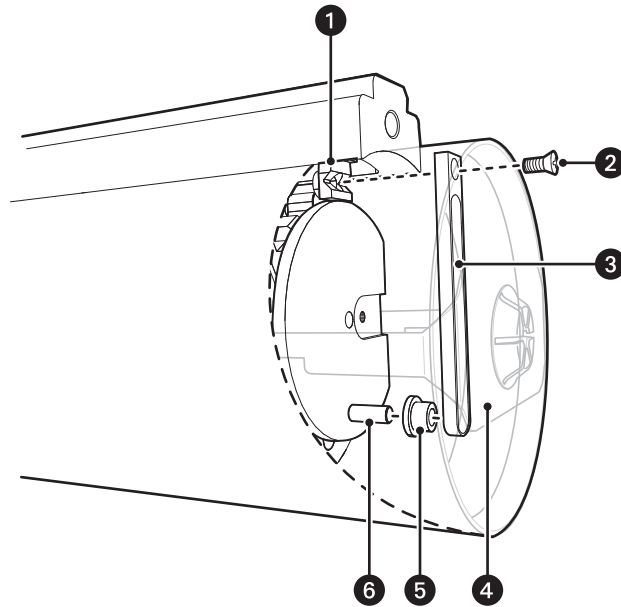

**Figure 12.** Remove/Install the Camera Module

- 1 Enclosure Tab
- 2 8-32 Phillips Flat Head Screw
- 3 Wiper Arm
- 4 Camera Module Handle
- 5 Green Bushing
- 6 Stud

- Slide the replacement camera module into the enclosure (refer to Figure 13).

**⚠ WARNING:** Never force the camera module into the enclosure.

*(Models with a wiper)* The tab located inside the enclosure must be pointing down before installing the camera module (refer to Figure 13). To position the tab, place the wiper blade (located at the front of the enclosure) in the center of the viewing window (refer to Figure 14).

- Carefully mate the camera's power connector to the mating connector located inside the enclosure.

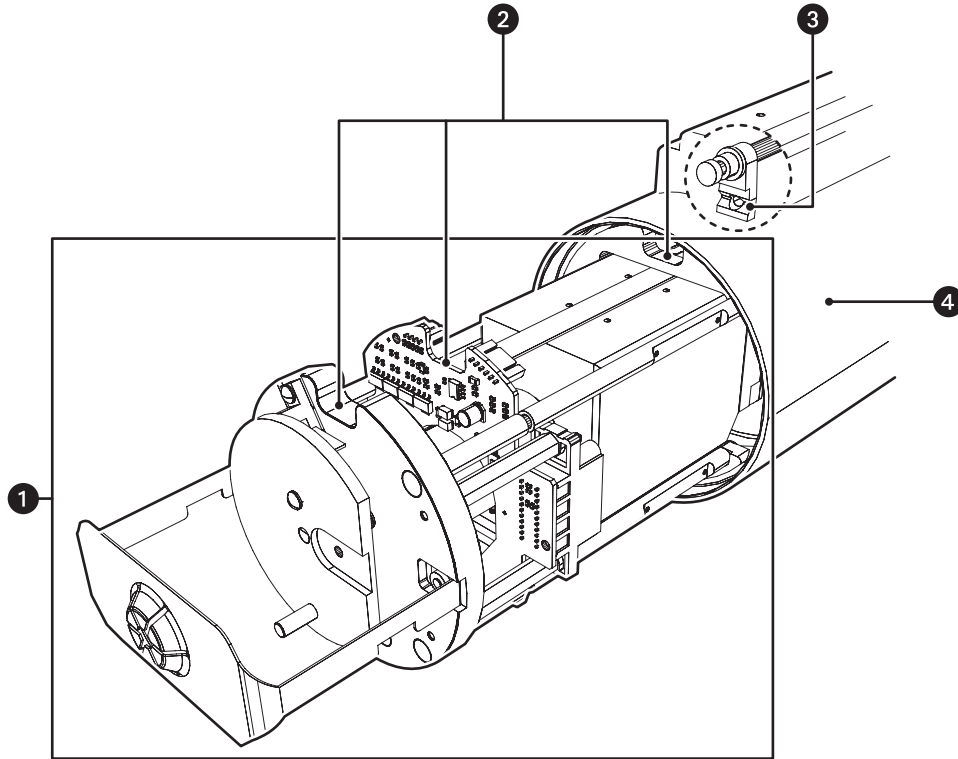

**Figure 13.** Install the Camera Module

- |                  |                    |
|------------------|--------------------|
| 1 Camera Module  | 3 Enclosure Tab    |
| 2 Center Notches | 4 Camera Enclosure |

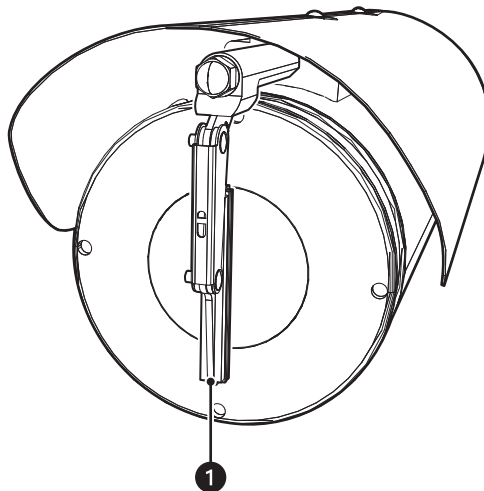

**Figure 14.** Center the Wiper Blade

- |               |
|---------------|
| 1 Wiper Blade |
|---------------|

7. *(Models with a Wiper)* Reinstall the wiper arm (refer to Figure 12 on page 15).
  - a. Reinstall the green bushing on the stud located behind the handle of the camera module.
  - b. Place the ridge of the wiper arm in the notch of the enclosure tab, and then place the slot of the wiper arm over the green bushing.
8. Secure the camera module and the wiper arm with the 8-32 Phillips flat head screw (refer to Figure 12 on page 15).



**WARNINGS:**

- To avoid thread damage, carefully install the back cap on the enclosure.
  - Never force the back cap onto the end of the enclosure.
  - When installation is completed, there should be no gap between the back cap and the enclosure.
9. Reinstall the back cap on the enclosure:
    - a. Using your hands, turn the back cap clockwise until you can no longer turn it. The back cap should turn easily until it comes in contact with the O-ring. If it does not turn easily, the threads are not aligned and thread damage will occur.
    - b. Continue tightening the back cap with the spanner wrench (supplied). There should be no gap between the back cap and the enclosure when the back cap is tightened and properly installed.
    - c. After the back cap is installed, secure the back cap with the setscrew using a 1.5 mm Allen wrench (supplied).

# Specifications

## ELECTRICAL

Input Voltage	24 VAC or 100 to 240 VAC, 50/60 Hz
Input Voltage Range	±10%
Power Consumption	Maximum 60 W (120 VA) per system
Electrical Connections	6-foot wire harness with connections for power, video, data control, alarm inputs, and auxiliary outputs

## MECHANICAL

Cable Entry	One 1.91 cm (0.75-inch) NPT threaded opening
Pan Movement	360° continuous pan rotation
Vertical Tilt	Unobstructed +90° to -90°
Variable Speeds	
Pan	0.1° to 40°/sec variable-speed operation
Tilt	0.1° to 40°/sec variable-speed operation
Preset Speeds	
Pan	40°/sec
Tilt	40°/sec

## GENERAL

Construction	316L stainless steel
Finish	Electropolish
Viewing Window	12.7 mm (0.50-inch) thick, soda-lime tempered glass
Operating Temperature	-60° to 60°C (-76° to 140°F)
Unit Weight	25 kg (55 lb)
Effective Projected Area (EPA)	40.8 square inches

**NOTE:** Please contact Pelco for information on the dimensions of the flameproof joints.

 NOTE: VALUES IN PARENTHESES ARE INCHES; ALL OTHERS ARE CENTIMETERS.

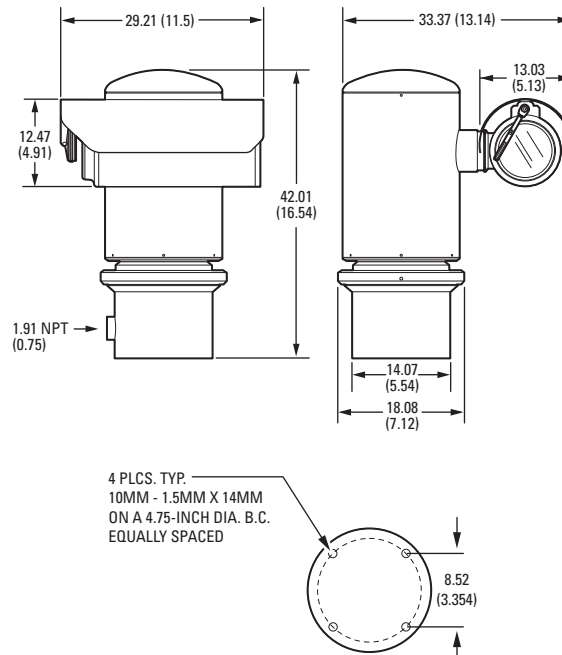

## CAMERA/OPTICS

Signal Format	NTSC, PAL
Scanning System	2:1 Interlace
Image Sensor	1/4-inch progressive scan CCD
Effective Pixels	
NTSC	768 (H) x 494 (V)
PAL	752 (H) x 582 (V)
Horizontal Resolution	
NTSC	540 TV lines
PAL	540 TV lines
Lens	f/1.4 (focal length, 3.3 ~ 119 mm optical)
Zoom	36X optical, 12X digital
Zoom Speed	2.9/4.2/5.8 seconds
Horizontal Angle of View	57.2° at 3.3 mm wide zoom 1.7° at 119 mm telephoto zoom
Focus	Automatic with manual override
Maximum Sensitivity at 35 IRE	
NTSC	0.018 lux at 1/2 sec shutter (color) 0.55 lux at 1/60 sec shutter (B-W) 0.00018 lux at 1/2 sec shutter (B-W)
PAL	0.015 lux at 1/1.5 sec shutter (color) 0.45 lux at 1/50 sec shutter (B-W) 0.00015 lux at 1/1.5 sec shutter (B-W)
Sync System	Internal/AC line lock, phase adjustable using remote control, V-Sync*
White Balance	Automatic with manual override*
Shutter Speed	Automatic (electronic iris)/Manual
NTSC	1/2 ~ 1/30,000*
PAL	1/1.5 ~ 1/30,000*
Iris Control	Automatic Iris Control with manual override*
Gain Control	Automatic/OFF*
Video Output	1 Vp-p, 75 ohms
Video Signal to Noise	>50 dB

*\*(Analog models only)* Manual control of camera setup functions can be done with CM6700, CM6800, CM8500, CM9500, CM9740, CM9760, CM9770, CM9780, KBD200A, KBD300A, and MPT9500 controllers. It cannot be done with CM7500, MPT9000, or KBD9000 controllers.

## VIDEO (ExSite IP Models Only)

Video Encoding H.264 base profile, MPEG-4, and MJPEG  
 Video Streams Up to 2 simultaneous streams; the second stream is variable based on the setup of the primary stream  
 Frame Rate Up to 30, 25, 24, 15, 12.5, 12, 10, 8, 7.5, 6, 5, 4, 3, 2.5, 2, 1  
 (dependent upon coding, resolution, and stream configuration)

Available Resolutions

Resolution			MJPEG		H.264 Base Profile		MPEG-4	
Width	Height	Format	Maximum IPS	Recommended Bit Rate	Maximum IPS	Recommended Bit Rate	Maximum IPS	Recommended Bit Rate
704	480	NTSC	30 ips	5.4 Mbps	30 ips	1.9 Mbps	30 ips	2.0 Mbps
352	240	NTSC	30 ips	1.3 Mbps	30 ips	0.5 Mbps	30 ips	0.6 Mbps
704	576	PAL	25 ips	5.4 Mbps	25 ips	1.9 Mbps	25 ips	2.0 Mbps

Supported Protocols

TCP/IP, UDP/IP (Unicast, Multicast IGMP), UPnP, DNS, DHCP, RTP, RTSP, NTP, IPv4, SNMP, QOS, HTTP, HTTPS, LDAP (client), SSH, SSL, SMTP, FTP, mDNS (Bonjour®), and 802.1x (EAP)

Users

Unicast Up to 20 simultaneous users depending on resolution settings (2 guaranteed streams)  
 Multicast Unlimited users H.264 or MPEG-4

Security Access

Password protected

Software Interface

Web browser view and setup, up to 16 cameras

Pelco System Integration

Endura® 1.5 or later (MPEG-4) or Endura 2.0 or later (H.264); Digital Sentry® 4.2 IP bundle 3 or later; DX8100 Series 2.0 or later; and DVR5100 version 1.5.4 or later

Open IP Integration

Pelco IP camera API

Minimum System Requirements

Processor Intel® Pentium® 4 microprocessor, 1.6 GHz  
 Operating System Microsoft® Windows® XP, Windows Vista®, Windows 7® or Mac® OS X 10.4 (or later)  
 Memory 512 MB RAM  
 Network Interface Card 100 megabits (or greater)  
 Monitor Minimum of 1024 x 768 resolution, 16- or 32-bit pixel color resolution  
 Web Browser\* Internet Explorer® 7.0 (or later) or Mozilla® Firefox® 3.0 (or later)  
 Media Player† Pelco Media Player or QuickTime® 7.6.5 for Windows XP, Windows Vista, or QuickTime 7.6.4 for Mac OS X 10.4

\*Internet Explorer is not supported by Mac OS X 10.4.

†This product is not compatible with QuickTime version 7.6.4 for Windows XP or Windows Vista. If you have this version installed on your PC, you will need to upgrade to QuickTime version 7.6.5.

## CERTIFICATIONS/RATINGS

- FCC
- UL/cUL Listed
- UL/cUL Hazardous Locations Listed per NEC Division and Zone requirement  
Class I, Groups A, B, C, and D  
Class II, Groups E, F, G, T5  
Class I, Zone 1, AEx d IIC
- AEx tD 21 T105°C
- BR-Ex d IIC, T5, IP66  
04/UL-BRAE-0027
- IECEx UL 11.0007X
- Ex d IIC T5 Gd
- Ex tb IIIC T105°C Db IP66
- DEMKO 04 ATEX 0413858X  
CE 0539 Ex II 2 G Ex d IIC, T5 Gb  
Ex II 2 D Ex tb IIIC T105°C Db IP66
- Tamb -60°C to 60°C
- NEPSI-China, Ex d IIC, T5, Cert No. GYJ05584
- C-Tick
- S Mark for Argentina
- Meets NEMA Type 4X standards
- ONVIF 1.02\*
- Lloyd's Register Type Approval: Marine, offshore, and industrial installations for use in environmental categories ENV1, ENV2, and ENV5; Certificate No. 06/60001†

\*Applies to IP models only.

†Applies to analog models only.



## PRODUCT WARRANTY AND RETURN INFORMATION

### WARRANTY

Pelco will repair or replace, without charge, any merchandise proved defective in material or workmanship **for a period of one year** after the date of shipment.

Exceptions to this warranty are as noted below:

- Five years:
  - Fiber optic products
  - Unshielded Twisted Pair (UTP) transmission products
  - CC3701H-2, CC3701H-2X, CC3751H-2, CC3651H-2X, MC3651H-2, and MC3651H-2X camera models
- Three years:
  - FD Series and BU Series analog camera models
  - Fixed network cameras and network dome cameras with Sarix® technology
  - Sarix thermal imaging products (TI and ESTI Series)
  - Fixed analog camera models (C20 Series, CCC1390H Series, C10DN Series, and C10CH Series)
  - EH1500 Series enclosures
  - Spectra® IV products (including Spectra IV IP)
  - Spectra HD dome products
  - Camclosure® IS Series integrated camera systems
  - DX Series video recorders (except DX9000 Series which is covered for a period of one year), DVR5100 Series digital video recorders, Digital Sentry® Series hardware products, DVX Series digital video recorders, and NVR300 Series network video recorders
  - Endura® Series distributed network-based video products
  - Genex® Series products (multiplexers, server, and keyboard)
  - PMCL200/300/400 Series LCD monitors
  - PMCL5xxF Series and PMCL5xxNB Series LCD monitors
  - PMCL5xxxBL Series LED monitors
- Two years:
  - Standard varifocal, fixed focal, and motorized zoom lenses
  - DF5/DF8 Series fixed dome products
  - Legacy® Series integrated positioning systems
  - Spectra III™, Spectra Mini, Spectra Mini IP, Esprit®, ExSite®, ExSite IP, and PS20 scanners, including when used in continuous motion applications
  - Esprit Ti and TI2500 Series thermal imaging products
  - Esprit and WW5700 Series window wiper (excluding wiper blades)
  - CM6700/CM6800/CM9700 Series matrix
  - Digital Light Processing (DLP®) displays (except lamp and color wheel). The lamp and color wheel will be covered for a period of 90 days. The air filter is not covered under warranty.

- Six months:
  - All pan and tilts, scanners, or preset lenses used in continuous motion applications (preset scan, tour, and auto scan modes)

Pelco will warrant all replacement parts and repairs for 90 days from the date of Pelco shipment. All goods requiring warranty repair shall be sent freight prepaid to a Pelco designated location. Repairs made necessary by reason of misuse, alteration, normal wear, or accident are not covered under this warranty.

Pelco assumes no risk and shall be subject to no liability for damages or loss resulting from the specific use or application made of the Products. Pelco's liability for any claim, whether based on breach of contract, negligence, infringement of any rights of any party or product liability, relating to the Products shall not exceed the price paid by the Dealer to Pelco for such Products. In no event will Pelco be liable for any special, incidental, or consequential damages (including loss of use, loss of profit, and claims of third parties) however caused, whether by the negligence of Pelco or otherwise.

The above warranty provides the Dealer with specific legal rights. The Dealer may also have additional rights, which are subject to variation from state to state.

If a warranty repair is required, the Dealer must contact Pelco at (800) 289-9100 or (559) 292-1981 to obtain a Repair Authorization number (RA), and provide the following information:

1. Model and serial number
2. Date of shipment, P.O. number, sales order number, or Pelco invoice number
3. Details of the defect or problem

If there is a dispute regarding the warranty of a product that does not fall under the warranty conditions stated above, please include a written explanation with the product when returned.

Method of return shipment shall be the same or equal to the method by which the item was received by Pelco.

### RETURNS

To expedite parts returned for repair or credit, please call Pelco at (800) 289-9100 or (559) 292-1981 to obtain an authorization number (CA number if returned for credit, and RA number if returned for repair) and designated return location.

All merchandise returned for credit may be subject to a 20 percent restocking and refurbishing charge.

Goods returned for repair or credit should be clearly identified with the assigned CA or RA number and freight should be prepaid.

Revised 10-9-12

 The materials used in the manufacture of this document and its components are compliant to the requirements of Directive 2002/95/EC.



This equipment contains electrical or electronic components that must be recycled properly to comply with Directive 2002/96/EC of the European Union regarding the disposal of waste electrical and electronic equipment (WEEE). Contact your local dealer for procedures for recycling this equipment.

### REVISION HISTORY

Manual #	Date	Comments
C1302M	11/04	Original version.
C1302M-A	2/05	Added 24 VAC power supply information per ECO 04-10256. Added maintenance section for camera module replacement.
C1302M-B	5/05	Changed wire color for Alarm COM per ECO 05-11019. Added warning to provide access to TX+ and TX- wires for software upgrade.
C1302M-C	7/05	Revised dimension drawing per ECO 05-11303.
C1302M-D	7/06	Updated for new factory-installed power module seal (ECO 06-14300). Revised power module installation instructions. Removed Figure 3.
C1302M-E	10/06	Removed color reference to power module seal (ECO 06-14300). Added power module warning. Added Figure 9.
C1302M-F	11/08	Changed camera specs per CN22046.
C1302M-G	7/09	Updated Important Safety Instructions section and added product certifications; UL certification requirement. Reference CN22827.
C1302M-H	2/11	Updated manual for ExSite IP release. Removed power module installation information. Created separate power module installation manuals: one for ExSite analog models and one for ExSite IP models.
C1302M-I	11/12	Updated manual to include UL regulatory review note for ATEX compliant products.



Pelco, Inc. 625 W. Alluvial, Fresno, California 93711 United States USA & Canada Tel (800) 289-9100 Fax (800) 289-9150  
International Tel +1 (559) 292-1981 Fax +1 (559) 348-1120  
[www.pelco.com](http://www.pelco.com) [www.pelco.com/community](http://www.pelco.com/community)