

Pelco IP Camera Installation Tool Quick Start Guide



Contents

Important Safety Instructions.....3

Important Notices4

 Regulatory Notices.....4

 Radio and Television Interference4

 Legal Notice4

Legal Notice (Audio Notice).....4

Warranty.....4

Package Content.....5

Dimensions5

Battery Installation.....6

Charging Battery6

Powering On7

Touch Panel Calibration7

Cable Test.....8

Power over Ethernet (PoE)9

IP Video - Camera / LAN Connection.....9

IP Video - Entering Live View Mode10

Analog Video - Connecting Cameras10

Connecting an IP Camera11

Restore Streaming Format13

Troubleshooting13

Pelco Troubleshooting Contact Information14

Important Safety Instructions

1. Read these instructions.
2. Keep these instructions.
3. Heed all warnings.
4. Follow all instructions.
5. Do not use this apparatus near water.
6. Clean only with dry cloth.
7. Only use attachments/accessories specified by the manufacturer.
8. Refer all servicing to qualified service personnel. Servicing is required when the apparatus has been damaged in any way, such as power-supply cord or plug is damaged, liquid has been spilled or objects have fallen into the apparatus, the apparatus has been exposed to rain or moisture, does not operate normally, or has been dropped.

CAUTION: Danger of explosion if battery is incorrectly replaced. Replace only with the same or equivalent type. Dispose of used batteries according to the instructions provided by the battery manufacturer.

The product and/or manual may bear the following marks:



This symbol indicates that there are important operating and maintenance instructions in the literature accompanying this unit



WARNING: This product is sensitive to Electrostatic Discharge (ESD). To avoid ESD damage to this product, use ESD safe practices during installation. Before touching, adjusting or handling this product, correctly attach an ESD wrist strap to your wrist and appropriately discharge your body and tools. For more information about ESD control and safe handling practices of electronics, please refer to ANSI/ESD S20.20-1999 or contact the Electrostatic Discharge Association (www.esda.org).

Important Notices

REGULATORY NOTICES

This device complies with Part 15 of the FCC Rules. Operation is subject to the following two conditions: (1) this device may not cause harmful interference, and (2) this device must accept any interference received, including interference that may cause undesired operation.

RADIO AND TELEVISION INTERFERENCE

This equipment has been tested and found to comply with the limits of a Class A digital device, pursuant to Part 15 of the FCC rules. These limits are designed to provide reasonable protection against harmful interference when the equipment is operated in a commercial environment. This equipment generates, uses, and can radiate radio frequency energy and, if not installed and used in accordance with the instruction manual, may cause harmful interference to radio communications. Operation of this equipment in a residential area is likely to cause harmful interference in which case the user will be required to correct the interference at his own expense.

Changes and Modifications not expressly approved by the manufacturer or registrant of this equipment can void your authority to operate this equipment under Federal Communications Commission's rules.

In order to maintain compliance with FCC regulations shielded cables must be used with this equipment. Operation with non-approved equipment or unshielded cables is likely to result in interference to radio and television reception.

This Class A digital apparatus complies with Canadian ICES-003.

Cet appareil numérique de la classe A est conforme à la norme NMB-003 du Canada.

LEGAL NOTICE

SOME PELCO EQUIPMENT CONTAINS, AND THE SOFTWARE ENABLES, AUDIO/VISUAL AND RECORDING CAPABILITIES, THE IMPROPER USE OF WHICH MAY SUBJECT YOU TO CIVIL AND CRIMINAL PENALTIES. APPLICABLE LAWS REGARDING THE USE OF SUCH CAPABILITIES VARY BETWEEN JURISDICTIONS AND MAY REQUIRE, AMONG OTHER THINGS, EXPRESS WRITTEN CONSENT FROM RECORDED SUBJECTS. YOU ARE SOLELY RESPONSIBLE FOR INSURING STRICT COMPLIANCE WITH SUCH LAWS AND FOR STRICT ADHERENCE TO ANY/ALL RIGHTS OF PRIVACY AND PERSONALTY. USE OF THIS EQUIPMENT AND/OR SOFTWARE FOR ILLEGAL SURVEILLANCE OR MONITORING SHALL BE DEEMED UNAUTHORIZED USE IN VIOLATION OF THE END USER SOFTWARE AGREEMENT AND RESULT IN THE IMMEDIATE TERMINATION OF YOUR LICENSE RIGHTS THEREUNDER.

Legal Notice (Audio Notice)

NOTE: Improper use of audio/visual recording equipment may subject you to civil and criminal penalties. Applicable laws regarding the use of such capabilities vary between jurisdictions and may require, among other things, express written consent from the recorded subjects. You are solely responsible for insuring strict compliance with such laws and for strict adherence to any/all right of privacy and personalty.

Warranty

For information about Pelco's product warranty and thereto related information, refer to www.pelco.com/warranty.

Package Content

The contents of a standard IP Camera Tester package are listed as below.

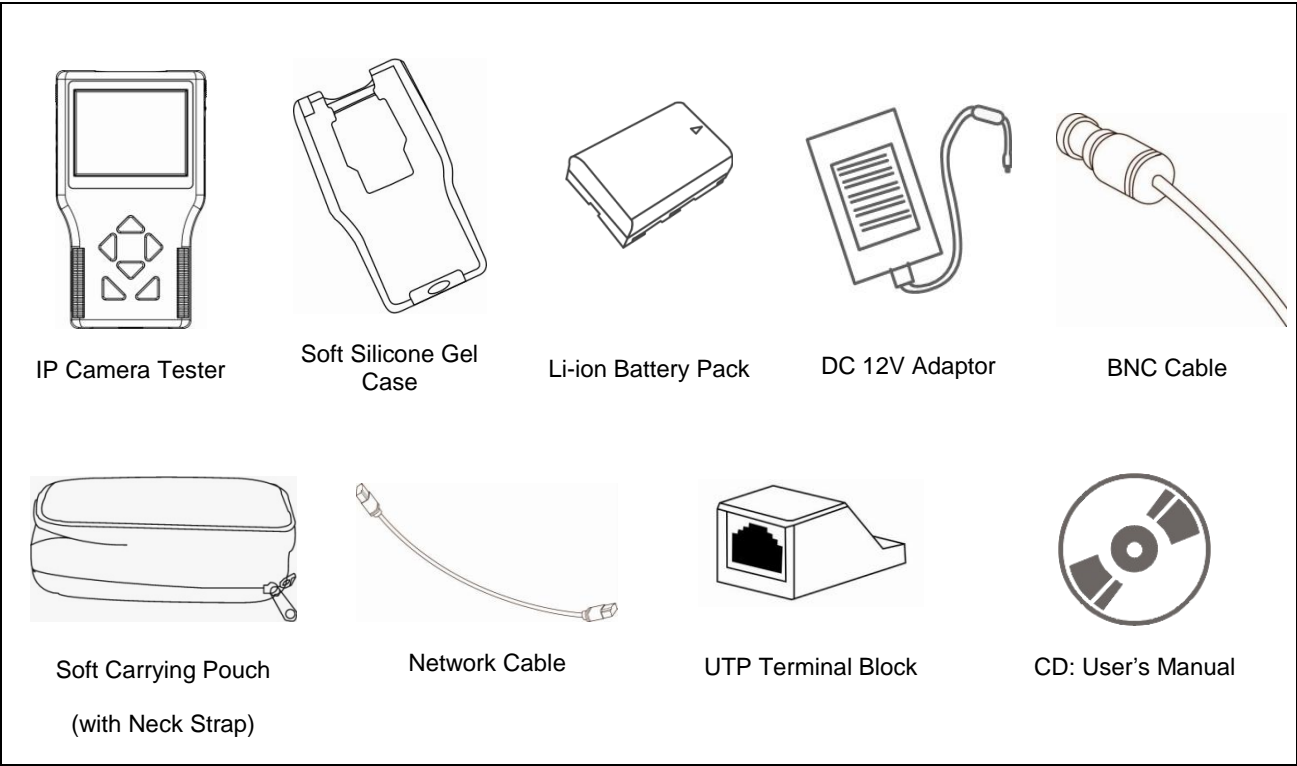

Dimensions

Please refer to the below diagram for the dimensions of the IP Camera Tester.

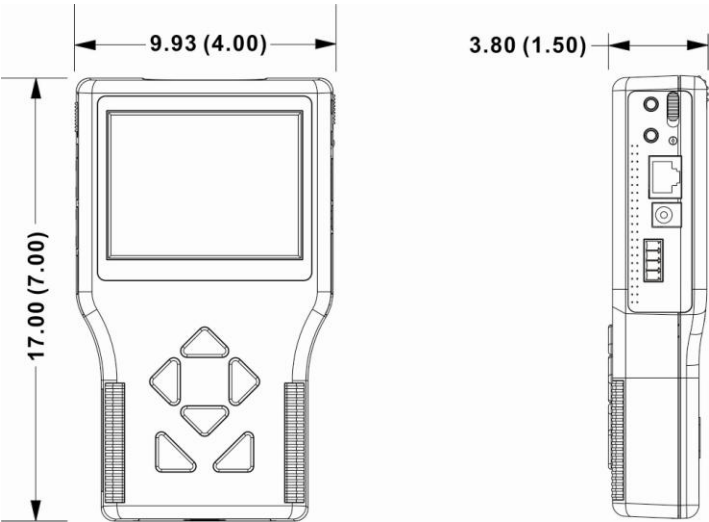

NOTE: VALUES IN PARENTHESES ARE INCHES; ALL OTHERS ARE CENTIMETERS.

Battery Installation

Please installed the battery by pushing the battery compartment cover outward and insert the battery with correct orientation.

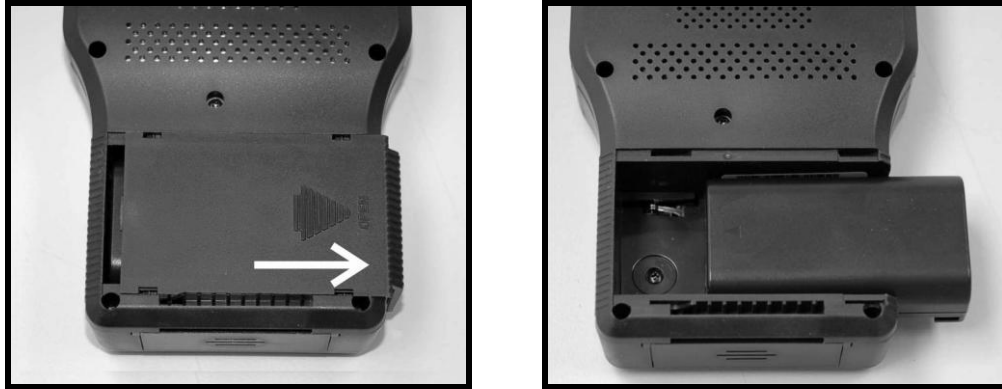

Charging Battery

The IPCT01 IP camera installation tool will support cameras with PoE IEEE802.3af, Class 2. Cameras with high power consumption (IEEE802.3at, Class 3) must use an external battery (purchased separately) with >9.0 Ah, or a high capacity battery with a charger solution similar to a BP-930 battery.

The fully charged Li-ion battery is able to support up to three hours of operating time, and takes approximately two hours to recharge.

To recharge the battery pack, please connect the DC 12V adaptor cord to the DC input jack on the side of the Tester. While battery is charging, the charging indicator LED will be on. The LED will be off after charging is completed.

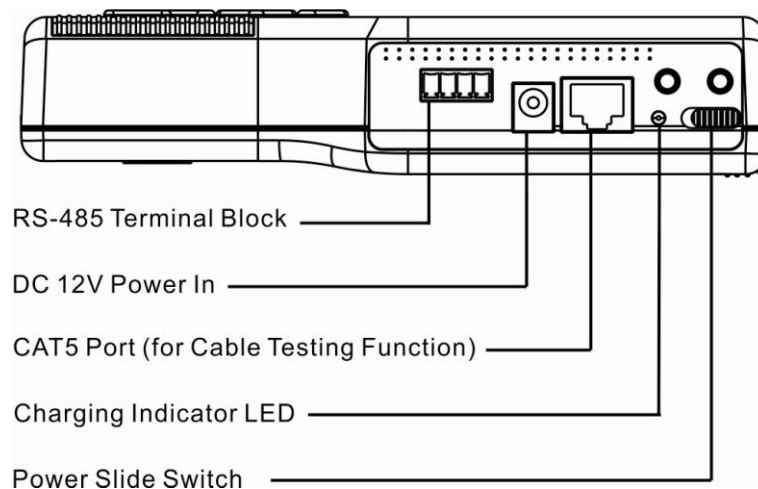

NOTE: The RS-485 Terminal Block is reserved for future option.

Powering On

To power on the IP Camera Tester, please set the Power Slide Switch on the side to “ON” position, and press and hold the Start Key  for 3 seconds (as shown in the left figure below).

The Tester will start booting up, with a loading bar displayed on the screen for about 10 seconds. In the mean time, the Data TX/RX Indicator LED will be blinking. The Home Screen will come out within 50 seconds, as shown in the right figure below.

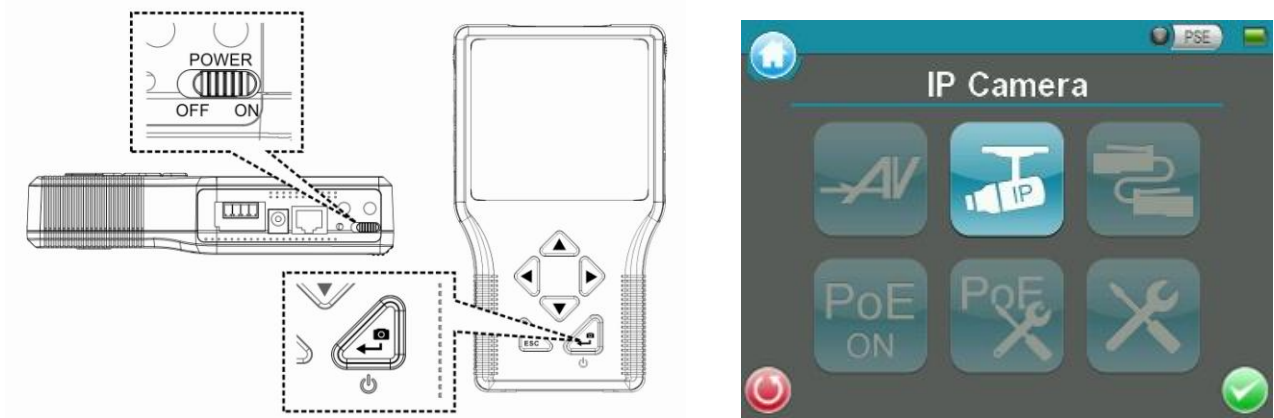

Touch Panel Calibration

On initial access, it is required to calibrate the touch panel. Please follow the steps below to complete the calibration.

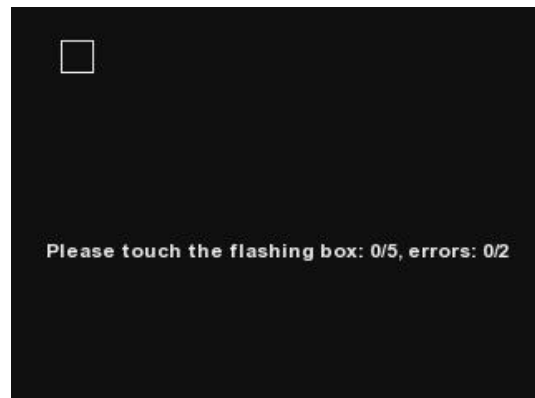
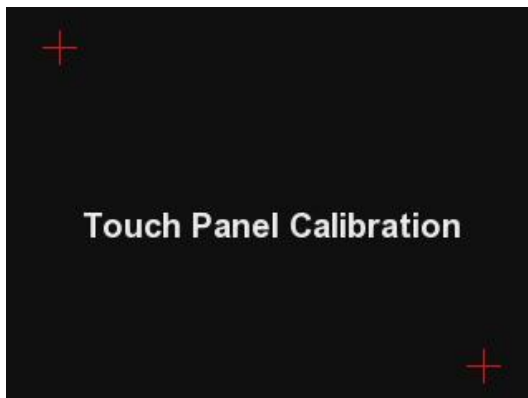

1. Tap the flashing cross (+) icon in the upper-left corner of the screen.
2. Tap the other flashing cross icon in the lower-right corner of the screen.
3. Tap all the appearing flashing boxes as instructed.



Cable Test

Access the Cable Test function to detect the type of the network cable (straight or crossover) and to test for errors (short, open or miswire).

Please follow the steps to test the network cables.

1. Connect one end of the CAT5 network cable to the UTP Terminal Block supplied with the IP Camera Tester.
2. Then connect the other end of the cable to the CAT5 port on the side of the Tester.
3. Tap the <Cable Test> button on the Main Menu (as shown in the left figure).
4. Tap the <Test>  button in the lower-right corner of the Cable Test page (as shown in the right figure).
5. Once the test is completed, the wire map of the cable will be displayed on the page.
6. Tap the <Return>  button to return to the Home Screen.

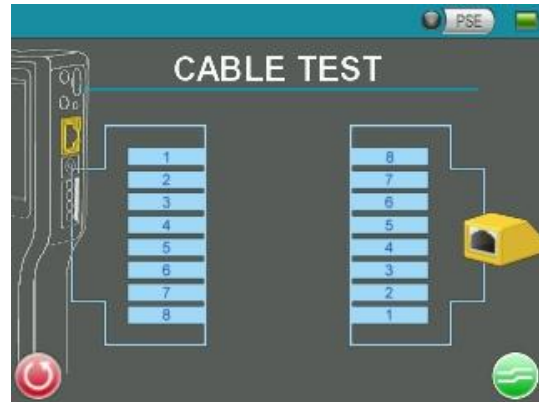

Power over Ethernet (PoE)

The IP Camera Tester can serve as a Power Sourcing Equipment (PSE) and provide power to an IP Camera that supports PoE.

To activate the PSE function, please connect the Ethernet cable from the IP Camera to the LAN / PoE OUT port on the side of the IP Camera Tester, and tap the <PoE ON>  button on the Main Menu. The PSE indicator light will be on as the camera extracts power from the IP Camera Tester's battery.

Internal Battery

The internal battery is able to provide up to 1.5 hours of operating time when powering a camera with PoE. The Power Bank Switch must be OFF while the battery is providing power to a PoE Camera.

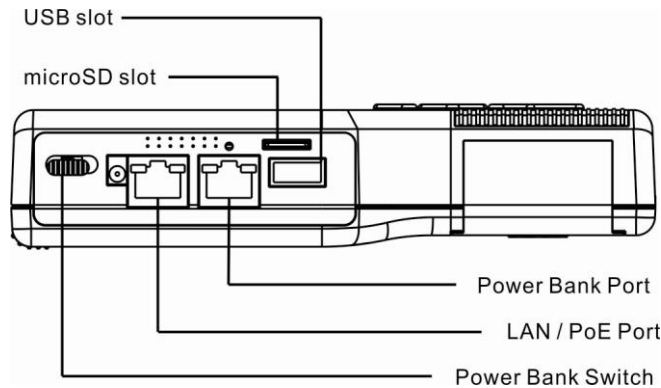

NOTE: The Power Bank accessory is a future option.

IP Video - Camera / LAN Connection

To access this function, please connect the network cable from the IP Camera / LAN to the LAN / PoE OUT port on the side of the Tester first.

Automatic changing of IP address

With the camera powered and the network cable connected, the IP address of the IP Camera Tester will be changed automatically to be compatible with the subnet of the camera.

Assigning an IP Address

Please assigned an IP address in the <IP Connection> page (Main Menu> Setup> Setup- IP> Setup- IP Connection). Users can set a static IP address for the Tester, or have an address assigned by DHCP. For more details, please refer to the User's Manual.

IP Video - Entering Live View Mode

To display live video of an IP Camera on the Tester, please follow this path: Main Menu> IP Camera. Inside the <IP Camera> function there are 2 kinds of methods to connect the IP Camera.

Direct Connection

Tap the <Connect> icon on the IP Camera submenu, and wait for the search to finish. Then the live video will be displayed on the LCD screen. Please check the network settings if the connection fails.



Device Search

Tap the <Device Search> icon, and wait for the search to finish. Select the target camera from the list of detected devices and tap the <CONNECT> button to connect the devices.



NOTE: Users must know the user name / password to access the camera.

Analog Video - Connecting Cameras

The IP Camera Tester can also be used as an analog video application to view analog videos.

To view the analogue video, please connect a BNC cable from the video output connector of the camera to the BNC IN port on the Tester.

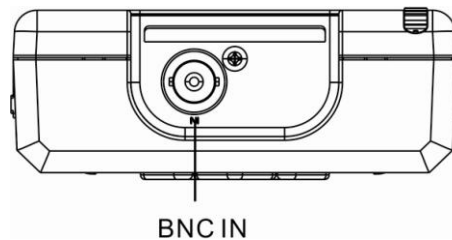

Connecting an IP Camera

Step 1:

Set up connection between the Tester and the IP Camera by plugging one end of the Ethernet Cable to the camera and the other end to the “LAN / POE OUT” connector on the Tester.

NOTE: The Power Bank function is a future option.



Step 2:

Turn on the Tester by switching the Power Slide Switch to “ON” and press the Start Key  for 3 seconds.





The IPCT01 IP Camera Installation Tool will support cameras with PoE IEEE802.3af, Class 2. Cameras with high power consumption (IEEE802.3at, Class 3) must use an external battery (purchased separately) with >9.0 Ah, or a high capacity battery with a charger solution similar to a BP-930 battery.

When connecting to an external battery, please set the power of the unit as follows:

Step 1: Access the Power setting menu.



Step 2: Select High setting.

Step 3:

Access the PSE function by pressing the <PoE ON>  button on the main menu page and the indicator light of the PSE  icon at the upper-right corner will change to yellow.



Step 4:

Tap the <IP Camera>  button on the main menu page, and tap the <Connect>  button to connect the camera.

NOTE: Users can also use the Device Search  button to search for the target camera.

**Step 5:**

If the IP Camera cannot be connected by using the function buttons in the <IP Camera> page, please go to the <Setup- IP connection> page and input the login information (Main Menu> Setup> Setup- IP> Setup- IP connection).

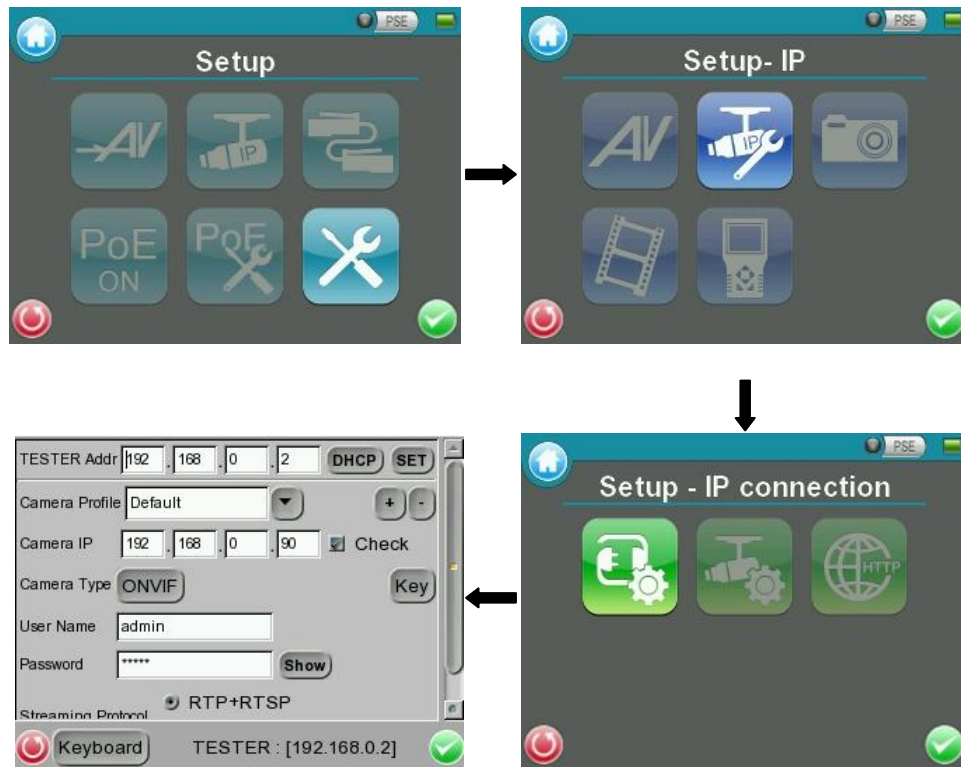
**Step 6:**

The Tester will start connecting to the target camera.

Step 7:

The Tester will display the live video of the connected IP Camera.

Restore Streaming Format

IMPORTANT. FOLLOW THIS PROCEDURE BEFORE EXITING CAMERA SET-UP. After the adjustment of the camera is finished, users can restore the streaming format to the default setting by pressing the <ESC> button . To display live video on the Tester, the camera's streaming format will be changed.

NOTE: Press the <ESC> button  to restore the camera to its original resolution format.

Troubleshooting

The followings are solutions to the error messages shown on the screen.

1. Power check.

The **IPCT01** IP Camera Installation Tool will support cameras with PoE IEEE802.3af, Class 2. Cameras with high power consumption (IEEE802.3at, Class 3) must use an external battery (purchased separately) with >9.0 Ah, or a high capacity battery with a charger solution similar to a BP-930 battery.

When connecting to an external battery, please set the power of the unit as follows:

Step 1: Access the Power setting menu.

Step 2: Select High setting.

2. "Please Check IP address"

Please double check if "Camera Type" is selected correctly (Main Menu> Setup> Setup- IP> Setup- IP connection> Camera Type).

3. "Name or password is wrong"

Please double check whether the user name / password are correct (Main Menu> Setup> Setup- IP> Setup- IP connection> User Name / Password).

4. "PoE OFF"

Please charge the battery if it is running low.

5. "Please Check IPCT01 or IP CAM Setting"

Please check the setting of the Tester or the network settings of the IP Camera.

Pelco Troubleshooting Contact Information

If the instructions provided fail to solve your problem, contact Pelco Product Support at 1-800-289-9100 (USA and Canada) or +1-559-292-1981 (international) for assistance. Be sure to have the serial number available when calling.

Do not try to repair the unit yourself. Leave maintenance and repairs to qualified technical personnel only.



This equipment contains electrical or electronic components that must be recycled properly to comply with Directive 2002/96/EC of the European Union regarding the disposal of waste electrical and electronic equipment (WEEE). Contact your local dealer for procedures for recycling this equipment.

PELCO

by Schneider Electric

Pelco by Schneider Electric 3500 Pelco Way Clovis, California 93612-5699 United States
USA & Canada Tel (800) 289-9100 Fax (800) 289-9150
International Tel +1 (559) 292-1981 Fax +1 (559) 348-1120
www.pelco.com www.pelco.com/community